

- LEGEND
- = FOUND IRON PIPE STAKE
 - = FOUND IRON REBAR STAKE
 - ⊙ = WATER VALVE LOCATED
 - = WOOD LIGHT POLE LOCATED
 - {xxx} = RECORDED AS

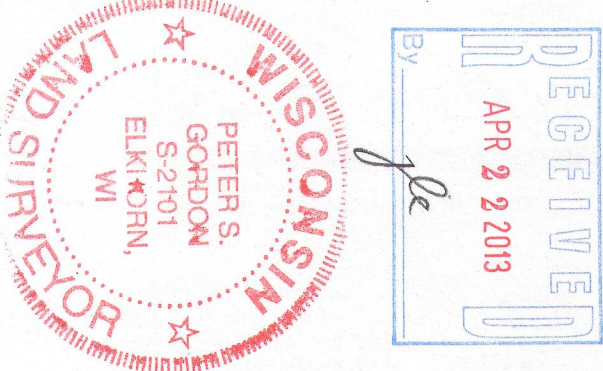

PLAT OF SURVEY
LOT 10 OF FAIRLANE SUBDIVISION ADDITION NO. 1
LOCATED IN PART OF THE SW 1/4 OF THE NW 1/4 OF SECTION 31,
TOWN 3 NORTH, RANGE 17 EAST, CITY OF ELKHORN,
WALWORTH COUNTY, WISCONSIN



NOTE: COPIES OF THIS MAP TO WHICH THE FOLLOWING CERTIFICATE WILL APPLY SHOW THE SURVEYOR'S ORIGINAL SEAL AND SIGNATURE IN RED INK. COPIES BY ANY OTHER MEANS MAY HAVE ALTERATIONS WHICH DO NOT REPRESENT THE SURVEYOR'S WORK PRODUCT.

I HEREBY CERTIFY THAT THE ABOVE DESCRIBED PROPERTY HAS BEEN SURVEYED UNDER MY DIRECTION AND THAT THE ABOVE MAP IS A TRUE REPRESENTATION THEREOF AND SHOWS THE SIZE AND LOCATION OF THE PROPERTY AND ITS EXTERIOR BOUNDARIES. THIS SURVEY IS MADE FOR THE USE OF THE PRESENT OWNERS OF THE PROPERTY, AND ALSO THOSE WHO PURCHASE, MORTGAGE, OR GUARANTEE THE TITLE THEREIN WITHIN ONE YEAR FROM THE DATE HEREOF.

DATED: 4/11/2013

PETER S. GORDON R.L.S. 2101

REVISIONS

FARRIS, HANSEN & ASSOCIATES, INC.
ENGINEERING - ARCHITECTURE - SURVEYING
7 RIDGWAY COURT P.O. BOX 437
ELKHORN, WISCONSIN 53121
OFFICE: (262) 723-2098 FAX: (262) 723-5886

— WORK ORDERED BY —
MARY BRANDT
6710 S. MILL GROVE ROAD
PEARL CITY, IL 61062

PLAT OF SURVEY

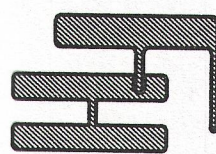

PROJECT NO. 8775
DATE: 04/11/2013
SHEET NO. 1 OF 1